

SITE DATA:

- OWNER:
FIRE SERVICE REAL ESTATE, INC SOL
15 S DOGWOOD TRL
KITTY HAWK, NC 27949
- SITE INFORMATION:
PIN: 586819516964
D.B. 1700, PG. 153
ZONING: COMMERCIAL
SITE AREA: 0.62 AC
SITE ADDRESS: 28 E DOGWOOD TRL
SOUTHERN SHORES, NC 27949
- ACCORDING TO FIRM MAP NUMBER 373086600K, DATED JUNE 19, 2020,
THE SITE IS NOT WITHIN A FLOOD HAZARD ZONE.
- BUILDING SETBACKS:
FRONT: 25'
SIDE (NORTH): 15'
SIDE (SOUTH): 10'
REAR: 25'
- IMPERVIOUS AREA CALCULATIONS:
EXISTING COVERAGE:
BUILDINGS: 4,609 SF (17.56%)
ASPHALT: 10,930 SF (40.85%)
CONCRETE/SIDEWALK: 3,192 SF (11.83%)
GREEN SPACE: 7,932 SF (29.63%)
TOTAL: 26,753 SF (100.0%)
TOTAL IMPERVIOUS: 18,621 SF (70.35%)

- PROPOSED COVERAGE:
BUILDING: 8,906 SF (33.29%)
ASPHALT: 8,126 SF (30.37%)
CONCRETE/SIDEWALK: 1,403 SF (5.26%)
GREEN SPACE: 8,315 SF (31.08%)
TOTAL: 26,750 SF (100.0%)
TOTAL IMPERVIOUS: 19,440 SF (72.69%)
DECREASE IN IMPERVIOUS AREA: 381 SF
6. PARKING:
REQUIRED: ONE SPACE/EMPLOYEE PLUS
ONE SPACE/FOUR SEATS IN TRAINING ROOM
10 EMPLOYEES AND 8 SEATS IN CONFERENCE ROOM:
12 SPACES REQUIRED
PROVIDED: 16 SPACES (INCLUDING 1 ADA)
 7. TYPE "B" BUFFER: A 10' WIDE BUFFER WITH VEGETATION THAT WILL REACH A HEIGHT OF 6' WITHIN THREE YEARS PLUS A FENCE WITH THE HEIGHT OF NO LESS THAN 6' ON THE OUTSIDE PERIMETER OF THE VEGETATION.
TYPE "C" BUFFER: A 5' WIDE VEGETATIVE BUFFER THAT WILL REACH A HEIGHT OF 3' WITHIN 3 YEARS PLUS EVERGREEN TREES THAT WILL REACH A HEIGHT OF 6' IN THREE YEARS AT NO MORE THAN 20' ON CENTERS
 8. DISTURBED AREA WILL NOT EXCEED 0.66 ACRES
 9. ALL MATERIAL REMOVED FROM SITE SHALL BE DISPOSED OF IN AN APPROVED LOCATION. ANY SOIL MATERIAL BROUGHT ON SITE SHALL COME FROM AN APPROVED MINE.
 10. TOPOGRAPHIC SURVEY PERFORMED BY TIMMONS GROUP APRIL 2022.

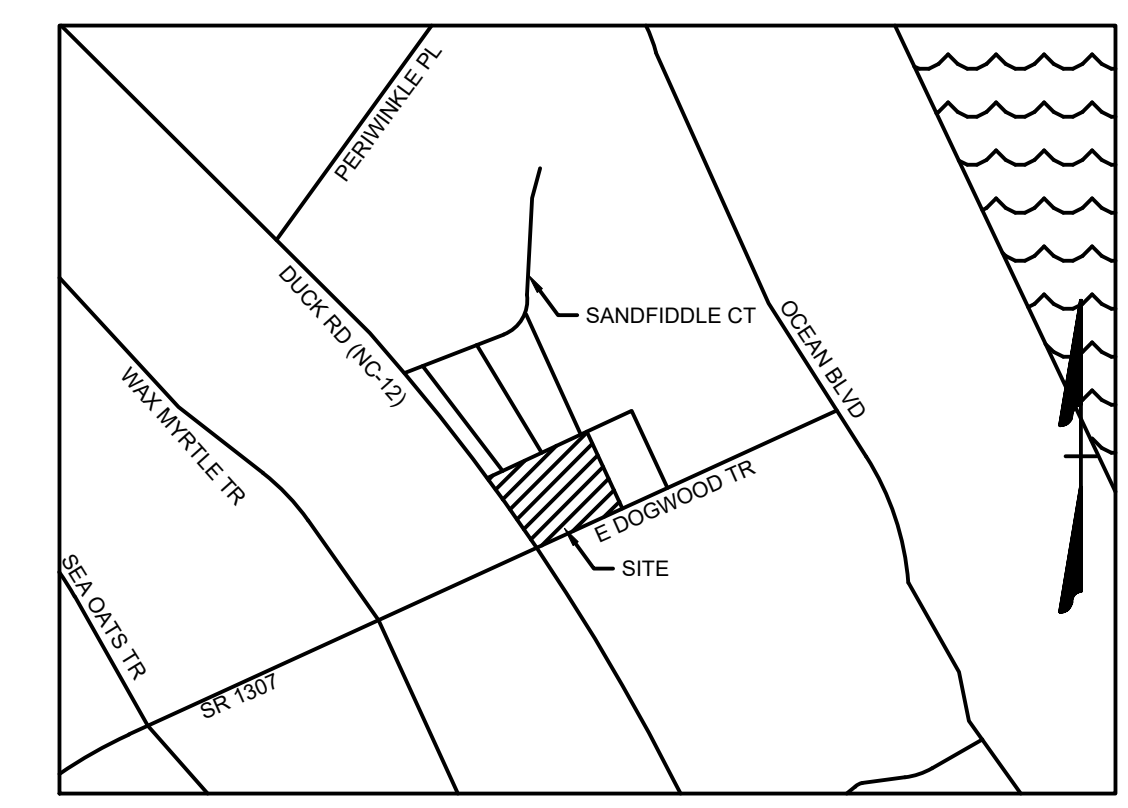

VICINITY MAP
NO SCALE

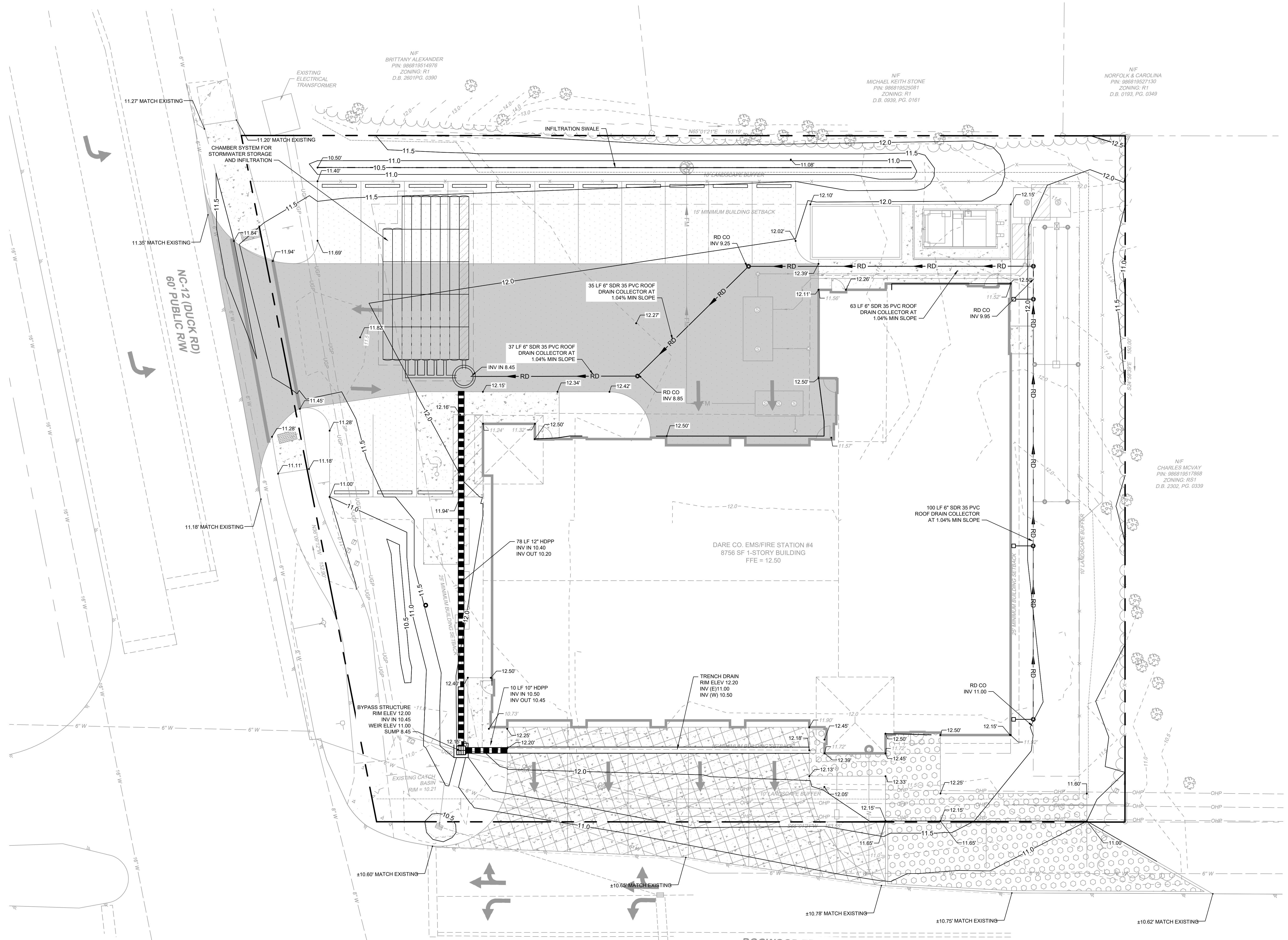

LEGEND

- BENCHMARK
- EX FIRE HYDRANT
- EX WATER VALVE
- EX WATER METER
- EX SEWER MANHOLE
- EX SEWER CLEANOUT
- EX POWER POLE
- EX GUY ANCHOR
- EX ELECTRIC METER
- EX TELECOM PEDESTAL
- EX SIGN
- EX TREE
- PROP SEWER CLEANOUT
- PROP SEWER MANHOLE
- PROP WATER VALVE
- PROP FIRE HYDRANT
- PROPERTY BOUNDARY
- RIGHT OF WAY
- SETBACK
- EX EDGE OF PAVEMENT
- EX FENCE
- EX OVERHEAD POWER
- EX 6" WATER LINE
- EX 8" WATER LINE
- EX 16" WATER LINE
- EX MAJOR CONTOUR
- EX MINOR CONTOUR
- EX EDGE OF TREE LINE
- PROP FENCE
- PROP MAJOR CONTOUR
- PROP MINOR CONTOUR
- PROP WATER LINE
- PROP SEWER LINE
- PROP FORCE MAIN
- PROP EDGE OF TREE LINE
- PROP DITCH/SWALE
- PROP LIGHT DUTY PAVEMENT
- PROP HEAVY DUTY PAVEMENT
- PROP CONCRETE
- PROP CONCRETE PAVEMENT

OAKLEY COLLIER ARCHITECTS
OCA ARCHITECTS
107 Condemwood Road, Rocky Mount, NC 27864 (P) 252.937.2300
1111 Haynes Street, Suite 109, Raleigh, NC 27604 (P) 919.963.7700

TIMMONS GROUP
YOUR VISION. OUR PASSION. YOUR SUCCESS.
1000 W. HAYNES STREET, SUITE 109
RALEIGH, NC 27604
TEL: 919.963.7700
WWW.TIMMONSGROUP.COM
North Carolina License No. C-1542

NEW BUILDING FOR
DARE COUNTY EMS STATION 4
28 E DOGWOOD TRAIL
SOUTHERN SHORES, NORTH CAROLINA



PERMIT DRAWINGS
NOT FOR CONSTRUCTION

GENERAL NOTE:
Prior to construction start, Contractor shall verify & be responsible for all dimensions.

Revisions #1-2022-08-24 UPDATES PER ARCHITECT COMMENTS	Date: 9/14/22	Project No: 52044.004
Drawn By: JBF	Checked By: KDH	Sheet No: C3.0
Sheet Title: GRADING PLAN		

Copyright © 2022, Oakley Collier Architects. These drawings are of the property of the Architect for use under his supervision. No reproduction or other use is allowed without permission.

